

**VEHICLE TECHNOLOGY**











# AGRICULTURAL

## TRAILER-COMPONENTS

## DEXKO

DexKo is set to deliver, market leadership in product development and innovation, improved customer service through the sharing of technology and best practices, increased manufacturing flexibility and great efficiency through global sourcing. DexKo's ongoing focus is profitable growth across its entire footprint through outstanding customer service, product quality and innovation, operational efficiencies and accretive acquisitions. We'll maintain the unparalleled customer service and product quality that the market has come to trust in both Dexter and AL-KO VT.

<p>Alois Kober laid the foundation for today's AL-KO Vehicle Technology with a forge in Großkötz in <b>1931</b>.</p>	<p>Start of production of handbrake levers <b>1952</b></p>	<p>Development and production of the hexagonal rubber spring axle <b>1967</b></p>	<p>AKS Lane holding systems <b>1975</b></p>	<p>Market launch of today's AL-KO CHASSIS <b>1985</b></p>	<p>Start of series production of ATC Trailer Control <b>2006</b></p>	<p>Introduction of the MAMMUT caravan manoeuvring system <b>2010</b></p>	<p>Milestones: 1 225.000 AL-KO motor chassis 1 25 million axles <b>2014</b></p>	<p>Successful merger between AL-KO Vehicle Technology and Dexter as DexKo Global Inc. <b>2016</b></p>			
											
<p>First foreign subsidiary in Austria <b>1961</b></p>	<p>AL-KO KOBER Southam, England Louhans, France Vintl, Italy Spreitenbach, Switzerland <b>1970</b></p>	<p>AL-KO KOBER USA <b>1983</b></p>	<p>AL-KO KOBER USA <b>1983</b></p>	<p>AL-KO Int. Australia <b>1988</b></p>	<p>AL-KO Damping Technology Hartha <b>1994</b></p>	<p>AL-KO Trailco South Africa <b>1999</b></p>	<p>Acquisition of Sawiko Fahrzeug-zubehör GmbH <b>2012</b></p>	<p>Acquisition of Bradley Doublelock <b>2014</b></p>	<p>Acquisition of Melbourne Trailer and Caravan Supplies (MTC) Australia <b>2016</b></p>	<p>Acquisition of BPW Fahrzeugtechnik <b>2017</b></p>	<p>Acquisition of Winterhoff GmbH <b>2016</b></p>

## DEXKO Global Inc. Active Worldwide

With more than 40 production sites and sales offices as well as roughly 1,000 service centres around the world, our network guarantees constant presence and personal contact. Our sophisticated logistics network around the entire globe optimises our flow of goods and guarantees a global presence 'just-in-time'. AL-KO quality and service is assured everywhere. You can count on that!

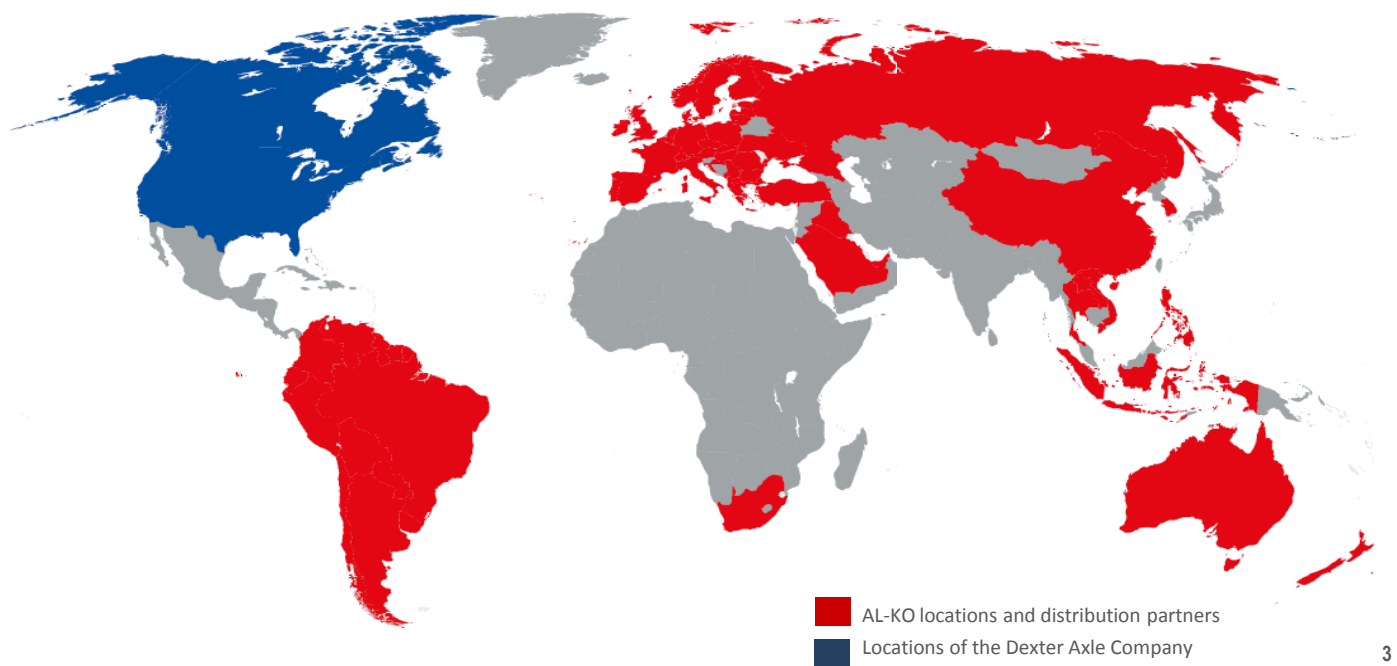

The name of AL-KO Vehicle Technology rightly applies as a synonym for safety on the roads. Whether motorhome, caravan, commercial vehicle or commercial trailer – as a reliable companion, our name stands for best possible driving safety and the highest levels of comfort. Not only in the leisure vehicle sector are we a byword to motorhome and caravan enthusiasts: With well-conceived lightweight chassis, chassis components as well as individual accessories, we guarantee a safe journey and enjoyment on your travels. With our premium solutions in the commercial vehicles and trailers segment, we also ensure the best ergonomics and safety during transport. We are one of the leading global axle suppliers in the lightweight weight range.



## AL-KO Vehicle Technology

The Vehicle Technology division includes the business segments automotive, plastic technology, damping technology and industrial components. AL-KO is a reliable partner for our customers in matters of driving safety and driving comfort.

Quality and safety have the most priority in the area of Vehicle Technology. Innovative production technologies and qualified employees guarantee the highest quality products for the highest degree of safety in road traffic. We are the worlds leading manufacturer in the area of chassis technology for commercial and domestic trailers, mobile homes and commercial vehicles. Produced are mainly trailer axles and components, chassis for caravans, trailer and motorhomes, Overrun and Ball Couplers, jockey wheels, hand winches and many other parts.



AL-KO has more than 80 years experience in the Vehicle technology division.

## Dexter

Since 1960, Dexter has served the North American utility trailer, recreational vehicle, heavy duty, manufactured housing, agricultural, marine, and specialty trailer markets.

Dexter has built a strong reputation as a progressive industry leader. We're an engineering-driven company dedicated to helping your company remain competitive, safe, and innovative. Over the past 50 years, OEMs have installed more than 50 million Dexter axles.

Dexter is owned by DexKo Global, formed at the end of 2015 by combining Dexter and AL-KO VT. This combination created a global leader in highly engineered trailer running gear components and systems, with over 130 years of trailer and caravan componentry experience.



## Bradley

The Bradley brand stands for the highest levels of quality and safety, and thus slots seamlessly into the AL-KO brand promise.

Outstanding constructions, extreme robustness, high longevity. And more than 90 years of experience in towing hitches and coupling components.

The product range has been designed for use including commercial, agriculture, military and public utilities. Bradley brands have established an unparalleled reputation for design, robustness, durability and quality across a wide range of products;

Trailer Components - couplings, jockey wheels & prop stands.

Towing Equipment - a range of towing jaws, mountings and pintles.

Towing Accessories - a wide range of pins, lanyards and other accessories for your Type Approved towing outfit.







## AGRICULTURAL TRAILER AXLES UNBRAKED

LOW SPEED UP TO 40km/h

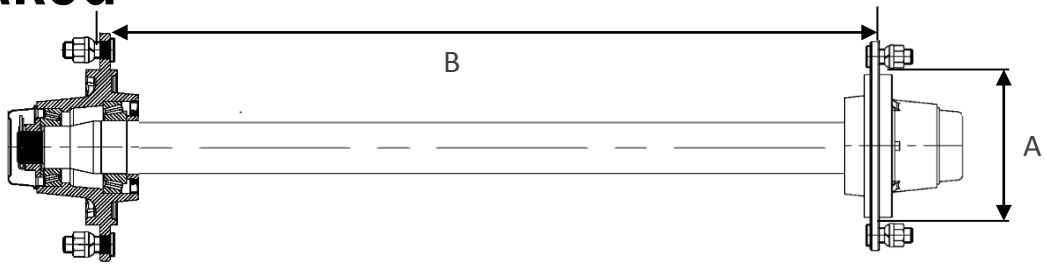

### Unbraked







Code	Diameter/ Solid Beam	Speed	Axle capacity each			PCD	Stud	A mm	OHF B mm	Bearings
										
1248048	55x55mm	25km/h	2900kg	3500kg	--	5 x 165	M16	-	1675/1700/1820	32008/30208
		40km/h	2700kg	3200kg	--					
1248034	60x60mm	25km/h	--	5000kg	--	6 x 205	M18x1.5	160	1700	30208/30211
		40km/h	--	4500kg	--					
1248035	60x60mm	25km/h	--	5000kg	--	6 x 205	M18x1.5	160	1820	30208/30211
		40km/h	--	4500kg	--					
1248315	70x70mm	25km/h	6000kg	7000kg	5000kg	6 x 205	M18x1.5	160	1800	32210/32213
		40km/h	5000kg	6000kg	4000kg					
1358201	80x80mm	25km/h	8000kg	9000kg	7000kg	8 x 275	M20x1.5	220	1830	32212/32215
		40km/h	7000kg	8000kg	6500kg					
1358207	80x80mm	25km/h	8000kg	9000kg	7000kg	8 x 275	M20x1.5	220	2200	32212/32215
		40km/h	7000kg	8000kg	6500kg					
1358208	90x90mm	25km/h	10000kg	11000kg	-	10 x 335	M22x1.5	281	1850	32214/32217
		40km/h	9000kg	10000kg	-					
1358209	100x100mm	25km/h	13000kg	14000kg	-	10 x 335	M22x1.5	281	2050	32214/32217
		40km/h	13000kg	14000kg	-					
1358210	100x100mm	25km/h	13000kg	14000kg	-	10 x 335	M22x1.5	281	2200	HM218248/32214
		40km/h	13000kg	14000kg	-					

**AGRICULTURAL TRAILER AXLES BRAKED**  
LOW SPEED UP TO 40km/h

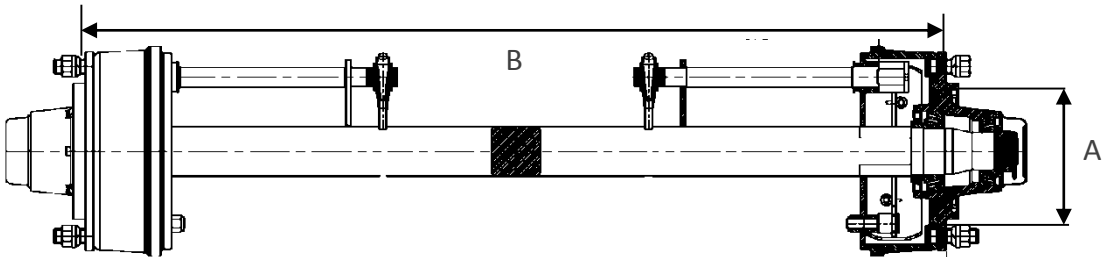

**Braked**



Code	Diameter/	Speed	Axle capacity each			PCD Brake	Stud	A mm	OHF B mm	Bearings
										
1248316	70x70mm	25km/h 40km/h	6000kg 5000kg	7000kg 6000kg	5000kg 4000kg	6 x 205 300 x 60	M18x1.5	160	1800	30209/30212
1358200	80x80mm	25km/h 40km/h	8000kg 7000kg	9000kg 8000kg	7000kg 6500kg	8 x 275 300 x 60	M20x1.5	220	1800	32212/32215 or 32210/32213
1358211	90x90mm	25km/h 40km/h	9500kg 9000kg	10500kg 10000kg	9000kg 8500kg	10 x 335 400 x 80	M22x1.5	281	1850	32214/32217
1358212	100x100mm	25km/h 40km/h	12500kg 12000kg	14000kg 14000kg	12000kg 11500kg	10 x 335 400 x 80	M22x1.5	281	2200	HM218248/32214

**AGRICULTURAL TRAILER RIMS 16'/18'**  
LOW SPEED

For Agricultural application and low speed up to 40km/h only  
Not for Motor driven Vehicles Use.



**16 INCH RIM 16x6 J 5H ONE PIECE SOLID DISH**

Code: 1248313  
PCD: 6 x 165.1 mm  
Bore center: 110.7 mm  
Hole diameter: 16.7 mm  
Offset: +15 mm  
Load bearing capacity: 1150kg  
Surface: Primer + Grey Paint  
Net Weight: 13 kg



**18 INCH RIM W9x18 ONE PIECE SOLID DISH**

Code: 1358701  
PCD: 6 x 205 mm  
Bore center: 161 mm  
Hole diameter: 21 mm  
Offset: 0 mm  
Load bearing capacity: 2850kg  
Surface: Primer + Grey Paint  
Net Weight: 21 kg



**18 INCH RIM W11x18 ONE PIECE SOLID DISH**

Code: 1358712  
PCD: 8 x 275 mm  
Bore center: 220 mm  
Hole diameter: 22 mm  
Offset: 0 mm  
Load bearing capacity:  
Surface: Primer + Paint  
Net Weight: 25 kg



**16 INCH RIM 6.5Hx16 LOCK RING TYPE**

Code: 1358703  
PCD: 6 x 205 mm  
Bore center: 161 mm  
Hole diameter: 20.5 mm  
Offset: 0 mm  
Load bearing capacity: 1850kg  
Surface: Primer + Grey Paint  
Net Weight: 26 kg

# TRAILER CAST-TURNTABLES

## LOW SPEED

- For Agricultural trailers and implements.
- Massive and rigid design
- Cast Iron

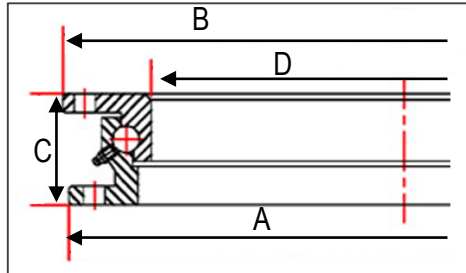

### TURN TABLE 400

Code: 1248333  
 Diameter: A=338mm B=400mm D=280mm  
 Height: C=52mm  
 Holes: 8 x 45 degree x 12.5mm Static  
 Surface: Primer + Black Paint  
 Net Weight: 15 kg



### TURN TABLE 685

Code: 1248307  
 Diameter: A=685mm B=700mm D=567mm  
 Height: C=80mm  
 Hauling Capacity: 3000kg  
 Static capacity: 1500kg  
 Surface: Primer + Black Paint  
 Net Weight: 50 kg



### TURN TABLE 880

Code: 1248306  
 Diameter: A=880mm B=895mm D=762mm  
 Height: C=80mm  
 Hauling Capacity: 5000kg  
 Static capacity: 2500kg  
 Surface: Primer + Black Paint  
 Net Weight: 70 kg



### TURN TABLE 1000

Code: 1248305  
 Diameter: A=1000mm B=1010mm D=859mm  
 Height: C=92mm  
 Hauling Capacity: 10000kg  
 Static capacity: 5000kg  
 Surface: Primer + Black Paint  
 Net Weight: 80 kg



### TURN TABLE 1100

Code: 1248304  
 Diameter: A=1100mm B=1115mm D=945mm  
 Height: C=90mm  
 Hauling Capacity: 12000kg  
 Static capacity: 6000kg  
 Surface: Primer + Black Paint  
 Net Weight: 99 kg

## TRAILER JOCKEY WHEELS / PARK STANDS HEAVY DUTY VERSIONS

**PRACTICAL TIP:** As a rule only static load bearing capacity is given in the market. Please consider that during manoeuvring, what is a dynamic loading, the load bearing capacity can be reduced up to 40% of the static load bearing capacity, as during the manoeuvring the load on jockey wheel increases accordingly. And the law for trailers on public roads states, in no case, the static vertical load on the coupling head of a trailer shall exceed 100kg (compulsory specification VC8026)

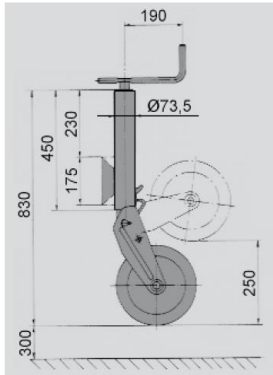

### JOCKEY WHEEL 73MM SEMI-AUTOMATIC

Code: 1250408  
 Static load bearing capacity: up to 800kg  
 Wheel: 260x65 steel rim  
 Travel: 500mm total  
 Feature: Fold-away handle  
 Operation: Wheel fork must be placed in the support fork lug on outer tube.

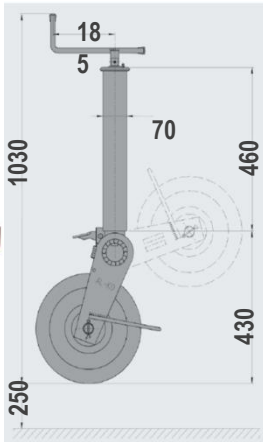
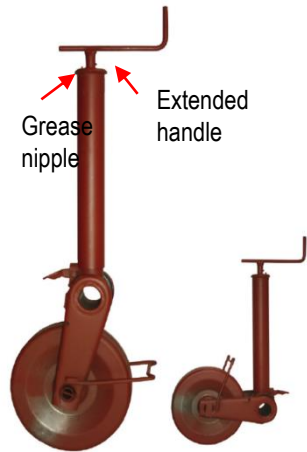

### JOCKEY WHEEL 60MM SEMI-AUTOMATIC

Code: 1224012  
 Load bearing capacity Static: up to 1500kg  
 Wheel: 310 x 90mm full steel wheel  
 Travel: 430mm + 250mm  
 Features: Foldaway fork + Grease nipple + extended handle  
 Operation: Wheel fork must be placed in the support fork lug on outer tube  
 Option: Loose weld-on bracket code 1224014 for different assembly height

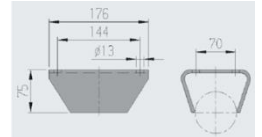
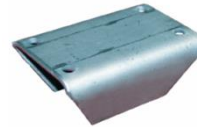

### ARMY JOCKEY WHEEL 73MM SEMI-AUTOMATIC

Code: 1248100  
 Static load bearing capacity: 800 kg  
 Bracket code 1248169



### JOCKEY WHEEL AUTOMATIC 73MM SEMI-AUTOMATIC

Code: 1366155  
 Static load bearing capacity: 800 kg

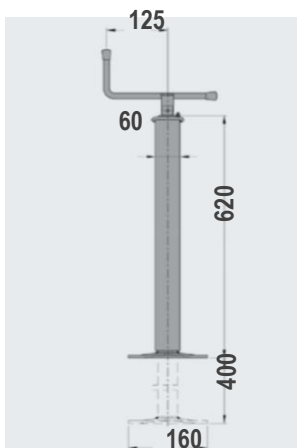

### PARKING PROP STAND 60MM SQUARE

Code: 1224016 without Tubemount  
 Code: with Tube mount  
 Load bearing capacity Static: up to 800kg  
 Foot plate: 160mm  
 Thrust bearing: yes  
 Travel: 400mm total  
 Features: Grease nipple



### PARKING PROP STAND 60MM SQUARE TUBE MOUNT.

Code: 1358714 with 60mm Tube Mount.  
 Feature: for 90 degree assembly during trailer towing.



## PIN - COUPLERS LOW SPEED

- For Agricultural tractors and vehicles.
- Speed limit max. 25km/h
- European Homologation

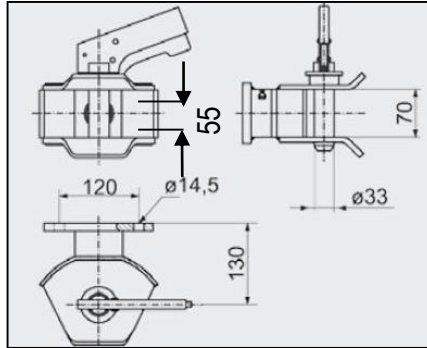

**PIN COUPLER AK61/1 Rotatable**  
 Code: 242079  
 Capacity: 6000kg Towing  
 Nose Load: 1000kg max.  
 Surface: Black paint coating  
 Net Weight: 7.0 kg  
 ECE approval  
 Mounting holes: 55mm  
 Rotatable Version including grease nipple

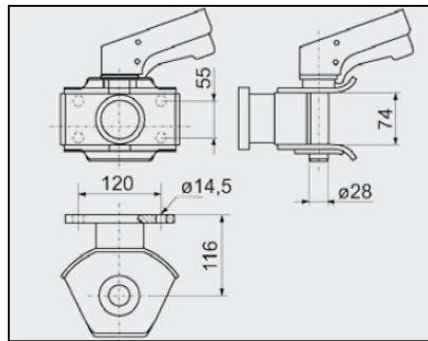

**PIN COUPLER AK53/B Fixed version**  
 Code: 203262  
 Capacity: 6000kg Towing  
 Nose Load: 500kg max.  
 Surface: Black paint coating  
 Net Weight: 6.6 kg  
 ECE approval  
 Mounting holes: 55mm

## WHEEL CHOCKS

- Tested according ECE standards (18 % uphill and downhill unladen and at permitted GVM)
- Comply with German Standard DIN 76051

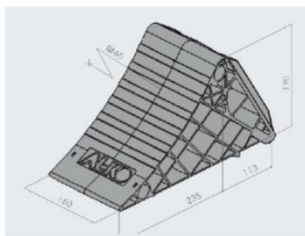
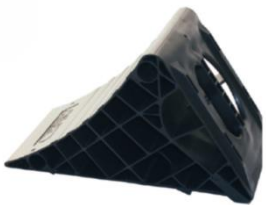

**WHEEL CHOCK UK46**  
 Code: 1221517  
 Holder Code: 244377  
 Wheel Load: 5000kg per Chock  
 Test Force: 65000 N min. per Chock  
 Static Wheel Radius: up to 460mm max.  
 Surface: Plastic injection moulding  
 Net Weight: 1.92 kg

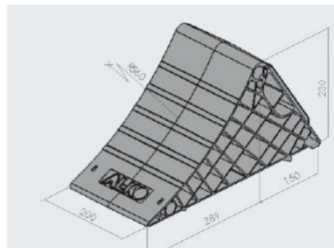

**WHEEL CHOCK UK53**  
 Code: 1221515  
 Holder Code: 244378  
 Wheel Load: 6500kg per Chock  
 Test Force: 84500 N min. per Chock  
 Static Wheel Radius: up to 530mm max.  
 Surface: Plastic injection moulding  
 Net Weight: 2.9 kg

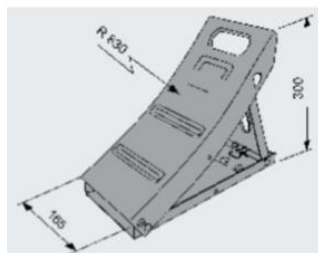

**WHEEL CHOCK UK800 FOLDABLE**  
 Code: 209425  
 Wheel Load: 2500kg per Chock  
 Static Wheel Radius: up to 830mm max.  
 Material/Surface: Metal / Black primer  
 Net Weight: 5.0 kg

## LEAF SPRINGS + COMPONENTS

### LOW SPEED



Code	Blades	Size	Length	Capacity/Pair	Width
1358721	12	70x10mm	1100mm	6000kg	70mm
Square Axle					

U BOLT PLATE					
1358720		140x10mm holes	97x92mm		
Square Axle					

U BOLT					
1358718		M16			
Square Axle					

## BRAKE CYLINDERS

### LOW SPEED

- For Agricultural braked axles.
- Speed limit max. 25km/h (low speed)



HYDRAULIC BRAKE CYLINDER	
Code:	1358023
Stroke:	100mm
Base:	150 x 40mm U Profile

Please ensure for correct spring pre-load, the brake cylinder is parallel (+- 5 degree) to the base plate when assembled to the slack adjuster lever on axle.

## TOWING EYE ROTATING

- For Agricultural Trailers
- Speed limit max. 25km/h (low speed)
- EC Approval



TOWING EYE 52MM 6000KG	
Code:	1358724
Capacity:	6000kg/Low speed
Inner diameter: 52mm	
Incl. Round bush for Rotating	

# DIXON-BATE TOWING PINTLES

Towing Pintles are hooks designed to rotate up to 360 degrees, enabling the trailer to rotate independently of the towing vehicle when off-road and on uneven terrain. The only products designed to tow trailers fitted with the military 3 inch/76mm Nato towing eye. Lock secured with steel pin & clip, supplied in a black electro-pheretic powder coat.

FOR AGRICULTURAL TRAILERS



BRADLEY FV987958 / AL-KO 185003815  
 (Nato ref: 2540-99-825-6119)  
 Land Rover Part No. NRC 2051

3.5T Light Towing Pintle  
 Towing Capacity 3.5T  
 D Value: 30.95kN  
 Towing Eye: Minimum i.D.: 75mm  
 Section thickness: 38-41mm  
 Lock secured with steel pin & clip  
 4 bolt fixing to Regulation 55  
 Bolts supplied



BRADLEY FV987957 / AL-KO 185011315  
 (Nato ref: 2540-99-825-6118)

7.5T Medium Towing Pintle  
 Towing Capacity 7.5T  
 D Value: 59.61kN  
 Towing Eye: Minimum i.D.: 75mm  
 Section thickness: 38-41mm  
 Lock secured with steel pin & clip  
 4 bolt fixing to Regulation 55  
 Bolts supplied

## 360° Pintle Rotation

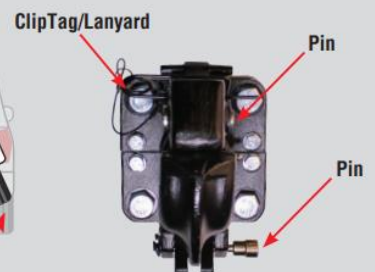
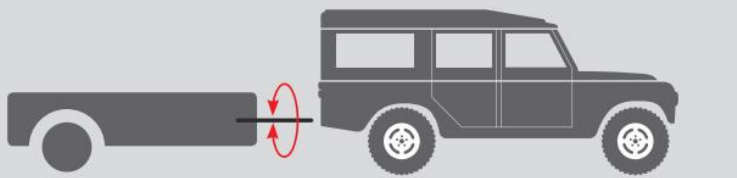



**AL-KO Pty. Ltd.**

(Head Office)

1 Bessemer Street

Vereeniging 1930

016 421-4791

016 421-2488 (fax)

email [info@alko.co.za](mailto:info@alko.co.za)

**AL-KO Johannesburg**

5 Susan Street

Strydompark

Randburg

011 791 1611

063 107 8118

[alko@northernoffroad.co.za](mailto:alko@northernoffroad.co.za)

**AL-KO Pretoria**

Corner Lussin Avenue and  
Zakheni Avenue

335 Sefako Makgatho Drive

Montana 0186

087 654 4960

[echozambesi@echo4x4.co.za](mailto:echozambesi@echo4x4.co.za)

**AL-KO Durban**

1 Wareing Road

Pinetown

KwaZulu-Natal

031 702 7291/09

**AL-KO Cape Town**

Unit 2 Jigman Park Montague Drive  
cross. Alternator Av.

Montague Gardens Milnerton 7441

021 551 5513

[infocpt@alko.co.za](mailto:infocpt@alko.co.za)

**AL-KO Polokwane**

163 Blaauwberg Street

Tel: 015 297 3279

**AL-KO Bothaville**

50 President Street

Tel: 083 739 0032